

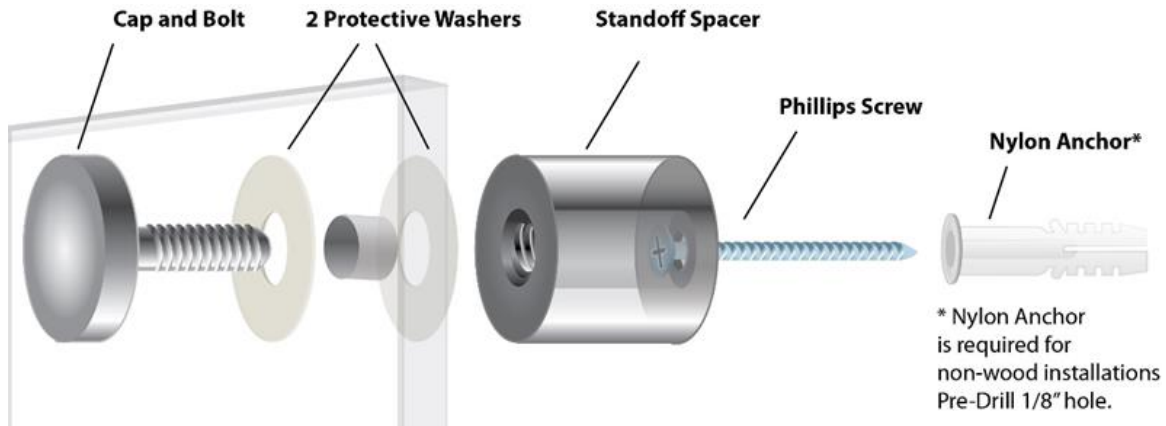

## STANDOFF MOUNTING INSTRUCTIONS



### Step 1: Mark the Wall for Hole Placement



Your sign has been predrilled with four appropriately sized holes in each corner. Depending on the size of your sign you may have additional holes and standoffs included with your sign. Have helpers hold the sign to the wall at the position you wish to mount it, ensuring that the sign is properly leveled.

**Mark** the center of each hole on the wall.

**Tip:** If your sign has a flat sign face (it does not include any protruding displays such as stoplights) you may find it easier to hold the sign to the wall with the face toward the wall. The holes are symmetrical so proper positioning will still be achieved.

### Step 2: Drill Pilot Holes

Drill a **1/8th** inch pilot hole at each marked location. Widen each hole to **1/4"** and **insert the plastic wall anchors.**

### Step 3: Attach Standoff Spacers

Attach each standoff spacer to the wall using a #2 Phillips screw provided with the kit.

### Step 4: Mount Sign

Have your helpers hold the sign over the mounted wall spacers and hand tighten each cap and bolt.

